



Building Products Inc.

**PRODUCT SUBMITAL SHEET**

TECH SUPPORT / SALES: 732-662-6200

**RC-2 Double Leg Resilient Channel**

Super Stud RC-2 is typically used for ceiling applications with multiple layers of gypsum board. It also enhances the STC rating of your metal or wood framing project. Used as a cross-furring member, RC-2 is installed perpendicular to the framing members. Pre-punched for easy attachment with holes 2" O.C. Screws should be used to attach RC -2 to metal or wood framing as nailing is not recommended.

**Product Specs**

**Material:** Grade 40 ksi minimum yield strength. G-40 Galv.

Design thickness: .0188" (25 GA)

**ASTM Standards**

- Super Stud Building Products Inc. manufactures nonstructural steel framing members, components, and accessories in compliance with American Iron & Steel Institute (AISI) and ASTM design A653, C645.
- Resilient channel is produced to meet ASTM C645.
- Galvanized sheet steel meets requirements of ASTM A924 and A1003
- Complete installation info is available on ASTM C754

**Sound rating for Assemblies**

Wall depth	Gypsum	Insulation	Spacing	Edge 25 plus RC-2 Est.
4 -7/8"	5/8" 1 plus 1	R-13 unfaced	24" o.c.	55 STC
5 -1/2"	5/8" 1plus 2	R-13 unfaced	24" o.c.	60 STC
6 -1/8"	5/8" 2 plus 2	R-13 unfaced	24" o.c.	62 STC

Please refer to Super Stud "The Edge" Steel Framing catalog for additional information on UL & STC ratings

Testing performed on 3 5/8" EDS 25 by Western Electro-Acoustic Laboratory [WEAL]. Plus 4 points for the resilient channel.

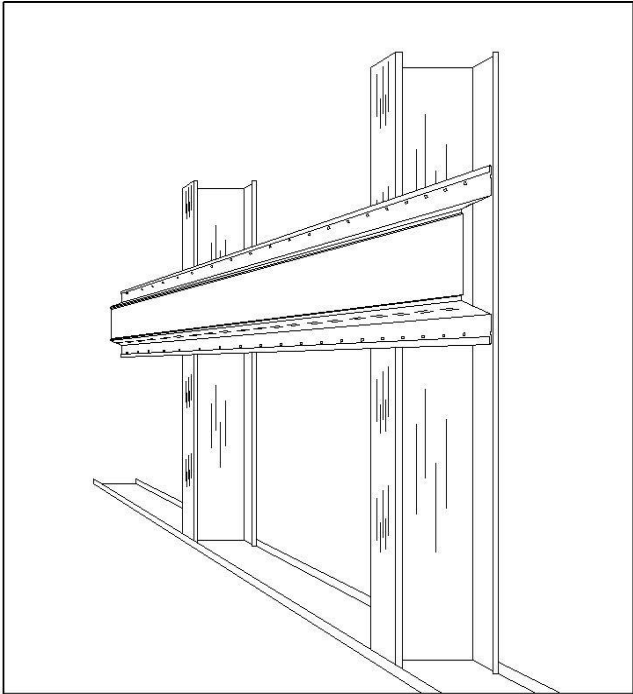

Suggested Installation:  
Fasten RC-2 to framing member using bottom mounting flange or alternate fastening bottom and top mounting flange.

**RC-2**  
**.0188"**

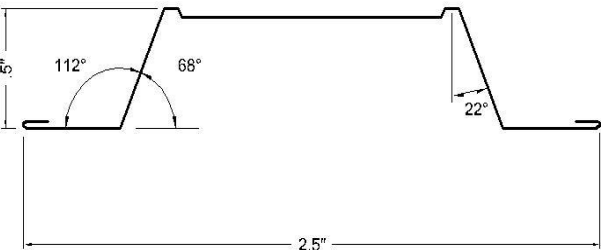

Tolerance  $\pm \frac{1}{16}$ "